

TECHNICAL DATASHEET



EF TEE 90°

04 Update - 03/2023

TECHNICAL DATA

Article No	001 117 2041 0160
d (mm)	160
D (mm)	204
Z (mm)	320
L (mm)	210
le1 (mm)	86
le2 (mm)	98
m (mm)	41,2
Weight (Kg)	4,272
Box Quantity (pcs)	3
Box Dimension (cm)	55x40x36

INJECTION MOULDED

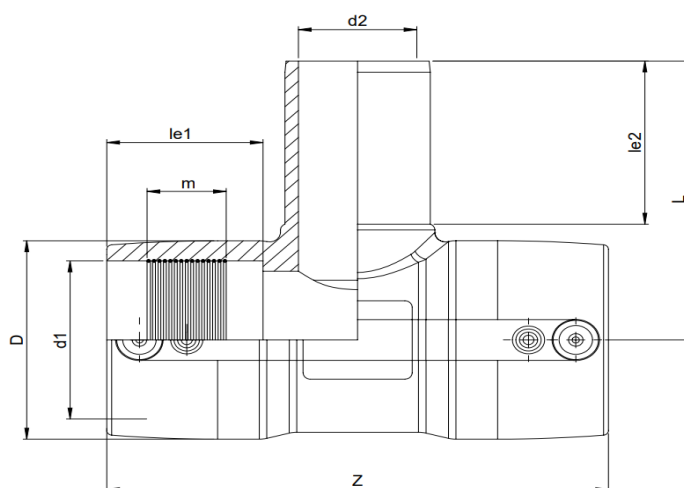

IDENTIFICATION OF PRODUCT

D(mm)	160
SDR	11
RAW MATERIAL	PE 100
PRESSURE CLASS	16 Bar Water 10 Bar Gas
TRADEMARK	NTG
EXECUTION	Injection Moulded
STANDARD	EN 12201-3 EN 1555-3 AS / NZS 4129
SPECIFICATION	Suitable for SDR9...17 pipe 4 mm pin connectors

EF SPECIFICATION

WELDING VOLTAGE	40V
RESISTANCE	0,91 Ω
WELDING TIME	360 Sec.
COOLING TIME	20 Min.
WINDING TYPE	Monofilar
WELDING BARCODE	



971420331603400916360110

Tolerance on diameters and thickness according to the standards. The other dimensions are specialized. Tolerance $\pm 5\%$. NTG PLASTIK reserves all the right to change any information without giving prior notice. The production, distribution and utilization of this document without explicit authorization is prohibited.